

## TECHNICAL INFORMATION SHEET

PART NUMBER:

**E10803M**

Diesel



**E10804M**

Petrol



**E10805M**

Petrol



**BMW** | X1, Series 1 and Series 3 | *from 2006*

### *Fuel Supply System*

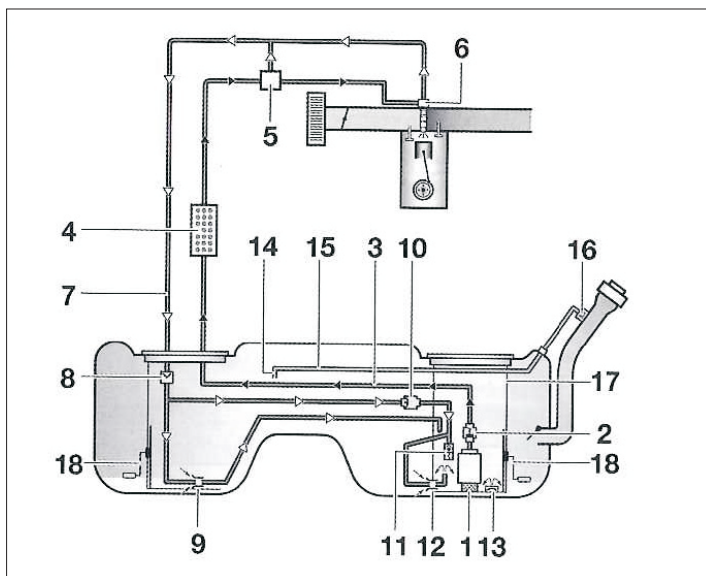

1. Electric Fuel Pump
2. Non return valve
3. Fuel supply line
4. Fuel filter
5. Fuel injection pump
6. Injectors
7. Fuel return line
8. Non return valve
9. Suction pump
10. Non return valve
11. Discharge valve
12. Suction pump
13. First filling valve
14. Respiration collector in filling
15. Respiration collector line in filling
16. Respiration in filling
17. Anticavitation reservoir
18. Fuel level senders

### **Fuel Pump Replacement**

**Specific tools:**

- Specific wrench [FIG. 1].

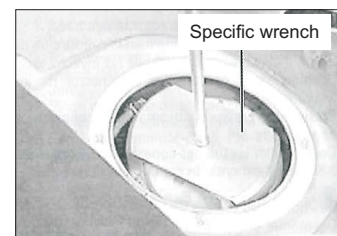

**FIG. 1**

## TECHNICAL INFORMATION SHEET

### Disassembly

The first steps, the most common for vehicles, are to disconnect the battery and the fuel pump relay, to drain the fuel tank and remove all necessary components to gain access to fuel pump.

Each vehicle may have fewer or more components to remove, which are specified on the vehicle's repair manuals.

- 1 The next step is to remove the bolts (1) [FIG. 3] and the cover (2) [FIG. 3].

- 2 Disconnect the electrical connectors (1) [FIG. 4].

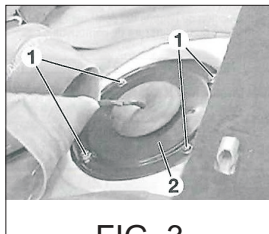

FIG. 3

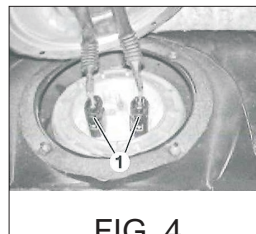

FIG. 4

- 3 Loosen the screw cap with the specific wrench aforementioned [FIG. 1].

- 4 Remove the fuel supply line (1) [FIG. 5] and the quick coupling (3) [FIG. 5] of the fuel return line (2) [FIG. 5].

- 5 Remove the Fuel Pump (24) [FIG. 2].

- AIRTEX RECOMMENDS:**
  - 6 Clean the fuel tank and replace the fuel filter.

### Assembly

- 1 Clean the joint faces, fit the new fuel pump, connect the fuel supply and return lines. Make sure the fuel level sender unit moves freely.
- 2 Make sure the rib (1) [FIG. 6] fits well into the groove (2) [FIG. 6] of the fuel tank.
- 3 Put the screw cap and tighten by hand. Then use the specific wrench to tighten the cap until the notch (1) [FIG. 7] is aligned with the mark (2) [FIG. 7].
- 4 Proceed with the rest of the assembly.

**PLEASE NOTE:** Fill up the fuel tank with fuel before switching on the engine.

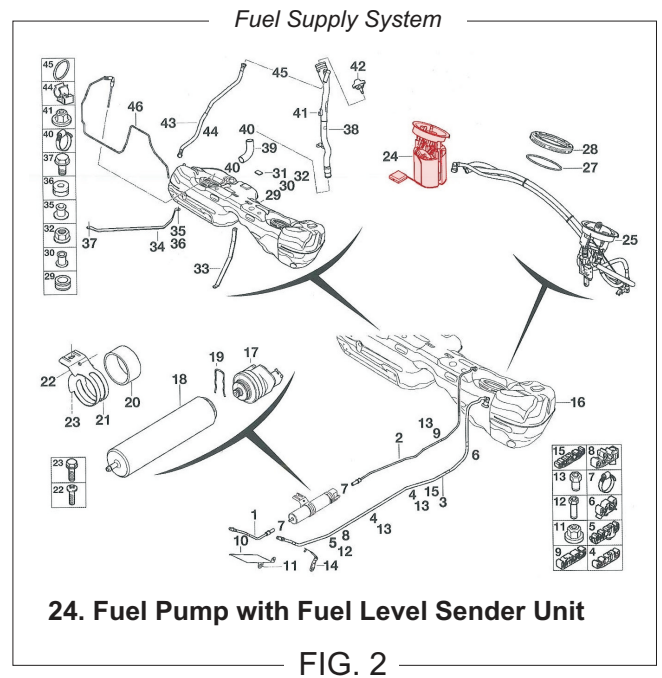

24. Fuel Pump with Fuel Level Sender Unit

FIG. 2

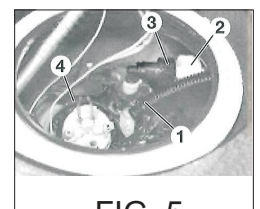

FIG. 5

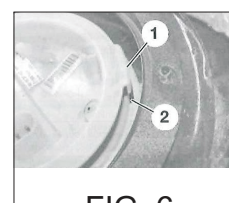

FIG. 6

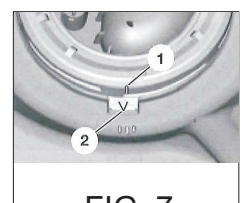

FIG. 7